

# Kwik-Cast™ & Kwik-Sil™

## Warranty

WPI (World Precision Instruments, Inc.) warrants to the original purchaser that this equipment, including its components and parts, shall be free from defects in material and workmanship for a period of one year from the date of receipt. WPI's obligation under this warranty shall be limited to repair or replacement, at WPI's option, of the equipment or defective components or parts upon receipt thereof f.o.b. WPI, Sarasota, Florida U.S.A. Return of a repaired instrument shall be f.o.b. Sarasota.

The above warranty is contingent upon normal usage and does not cover products which have been modified without WPI's approval or which have been subjected to unusual physical or electrical stress or on which the original identification marks have been removed or altered. The above warranty will not apply if adjustment, repair or parts replacement is required because of accident, neglect, misuse, failure of electric power, air conditioning, humidity control, or causes other than normal and ordinary usage.

To the extent that any of its equipment is furnished by a manufacturer other than WPI, the foregoing warranty shall be applicable only to the extent of the warranty furnished by such other manufacturer. This warranty will not apply to appearance terms, such as knobs, handles, dials or the like.

WPI makes no warranty of any kind, express or implied or statutory, including without limitation any warranties of merchantability and/or fitness for a particular purpose. WPI shall not be liable for any damages, whether direct, indirect, special or consequential arising from a failure of this product to operate in the manner desired by the user. WPI shall not be liable for any damage to data or property that may be caused directly or indirectly by use of this product.

## Claims and Returns

- Inspect all shipments upon receipt. Missing cartons or obvious damage to cartons should be noted on the delivery receipt before signing. Concealed loss or damage should be reported at once to the carrier and an inspection requested. All claims for shortage or damage must be made within 10 days after receipt of shipment. Claims for lost shipments must be made within 30 days of invoice or other notification of shipment.

Please save damaged or pilfered cartons until claim settles. In some instances, photographic documentation may be required. Some items are time sensitive; WPI assumes no extended warranty or any liability for use beyond the date specified on the container.

- WPI cannot be held responsible for items damaged in shipment en route to us. Please enclose merchandise in its original shipping container to avoid damage from handling. We recommend that you insure merchandise when shipping. The customer is responsible for paying shipping expenses including adequate insurance on all items returned.

- Do not return any goods to WPI without obtaining prior approval and instructions (RMA#) from our returns department. Goods returned unauthorized or by collect freight may be refused. The RMA# must be clearly displayed on the outside of the box, or the package will not be accepted. Please contact the RMA department for a request form.

- Goods returned for repair must be reasonably clean and free of hazardous materials.

- A handling fee is charged for goods returned for exchange or credit. This fee may add up to 25% of the sale price depending on the condition of the item. Goods ordered in error are also subject to the handling fee.

- Equipment which was built as a special order cannot be returned.

- Always refer to the RMA# when contacting WPI to obtain a status of your returned item.

- For any other issues regarding a claim or return, please contact the RMA department

**Warning: This equipment is not designed or intended for use on humans.**



# Kwik-Cast™ & Kwik-Sil™

*Silicone elastomers cure in five minutes*

www.wpiinc.com

## INSTRUCTION MANUAL

Serial No. \_\_\_\_\_



## World Precision Instruments, Inc.

### USA

International Trade Center, 175 Sarasota Center Blvd., Sarasota FL 34240-9258  
Tel: 941-371-1003 • Fax: 941-377-5428 • E-mail: sales@wpiinc.com

### UK

Astonbury Farm Business Centre • Aston, Stevenage, Hertfordshire SG2 7EG  
Tel: 01438-880025 • Fax: 01438-880026 • E-mail: wpiuk@wpi-europe.com

### Germany

Liegnitzer Str. 15, D-10999 Berlin  
Tel: 030-6188845 • Fax: 030-6188670 • E-mail: wpide@wpi-europe.com

### Internet

www.wpiinc.com • www.wpi-medical.com  
www.nitricoxide.net • www.pipetter.com

120605

**World Precision Instruments**



**Kwik-Sil** and **Kwik-Cast** are packaged in an easy-to-use dual-syringe applicator which eliminates the introduction of air bubbles during mixing and causes a more consistent curing time.

These silicones are based on recently developed technology with vinyl terminated siloxane and platinum complex catalysts. In order to gain enough speed to cure at room temperature, special cross linkers and high catalyst concentration is used. Although the high concentration of catalysts makes these products more costly than traditional RTV silicones and less attractive for general usage, they provide an excellent value in applications for the biological research field.

Both **Kwik-Sil** and **Kwik-Cast** have very low toxicity before, during and after curing. In traditional RTV silicone systems, a by-product of the condensation (curing) is either acetic acid or alcohol, which are toxic to living cells. In vinyl systems, the by-product of condensation is a small amount of hydrogen gas, which is much less toxic to the cell.

**Kwik-Sil** and **Kwik-Cast** curing speed is hundreds of times faster than traditional RTV silicones. A curing time of a few minutes at room temperature is especially useful for encapsulation of live tissue or implanting into a live animal.

Unlike many vinyl-based silicones in which the platinum complex catalysts are easily poisoned by contamination from amines and animal tissue, **Kwik-Sil** and **Kwik-Cast** are not sensitive to contamination from animal tissue.

**Kwik-Sil** is a translucent, medium-viscosity silicone adhesive, developed for chronic peripheral nerve studies such as anterograde tracing with fluorescent indicators or electrode recording. Good adhesion and mechanical properties (tear strength and elongation) allow days of study without breaking of the bonding. Curing speed is very reproducible.

**Kwik-Cast** is a very low viscosity silicone sealant developed to embed peripheral nerves with electrodes for acute multifiber recordings. It flows easily, filling the small spaces around the nerve and leaving no channels through which peritoneal fluid can travel and thus short the nerve/electrode contact. Equally important is the ability of the material to flow into itself and create one continuous mass from underneath the nerve all the way to the top of the nerve/electrode contact to ensure a long term recording stability.

**Kwik-Cast** is color-coded to make the mixing foolproof. The catalyst is yellow and the base is blue; when uniformly mixed, it is green. **Kwik-Cast** can be applied and cured underneath mineral oil. After recording, electrodes are easily recovered due to the low tear strength.

## Important information

Store below 27 °C.

Keep the applicator capped to avoid air contamination when not in use. To remove air bubbles from tip area, place capped syringe upright for several hours or over-night before use. The cap is keyed so that it can only be put on in one direction, to avoid cross-contamination of catalyst and base.

## Mixing and Application

The new dual-syringe applicator mixes the silicone as you apply it. To use, remove the white protective cap from the syringe, slip on a mixer tip (supplied in a separate bag) and turn it 90 degrees to lock the tip in position. As the silicone is extruded from the syringe and applied directly onto the subject, it will automatically be mixed by the tip. (The disposable mixer tip can only be used once because the silicone inside will become solid very quickly. Only a very small amount of silicone will be wasted in the tip because its dead volume is less than 0.12 mL.)

After dispensing the silicone, the mixer tip may be left on the syringe until next application and replaced by a new one. However, if the silicone is not going to be used for several days, we recommend covering the syringe with the protective cap. Please note that the cap is keyed so that it can only be put on in one direction.

## Specifications

UNMIXED:	Kwik-Sil	Kwik-Cast
Mix Ratio	1:1	1:1
Working time*	90 seconds	4 minutes
Viscosity, cps	15,000	10,000
Setting time (room temperature, 1:1 ratio)	<10 minutes	<10 minutes
Shelf life at 23 °C	>1 year	>1 year
Volume	5 mL	5 mL
Number of mixing tip	12	12
Dead volume of the mixing tip	<0.12 mL	<0.12 mL
AFTER CURING 24 HOURS:		
Tear Strength, ppi	90	44
Elongation %	650	60
Durometer (shore A-2)	30	36
Color	translucent	green
Volume Resistivity, W/cm	1x10 <sup>15</sup>	1x10 <sup>15</sup>

10 mixer tips are included. If additional mixer tips are needed, order WPI part #600009 (package of 10).

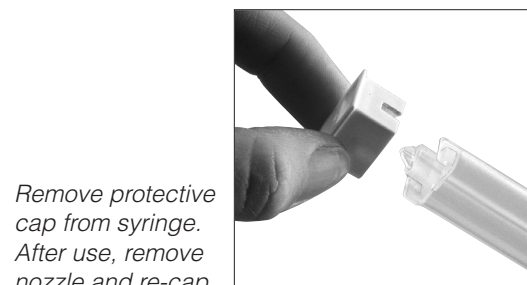

Remove protective cap from syringe. After use, remove nozzle and re-cap.

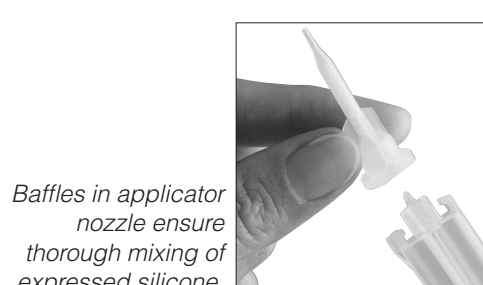

Baffles in applicator nozzle ensure thorough mixing of expressed silicone.

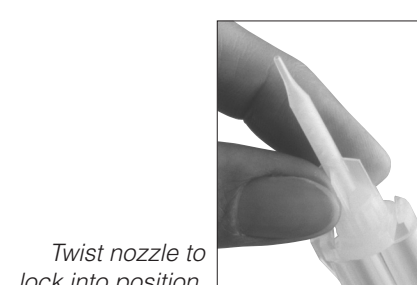

Twist nozzle to lock into position.